

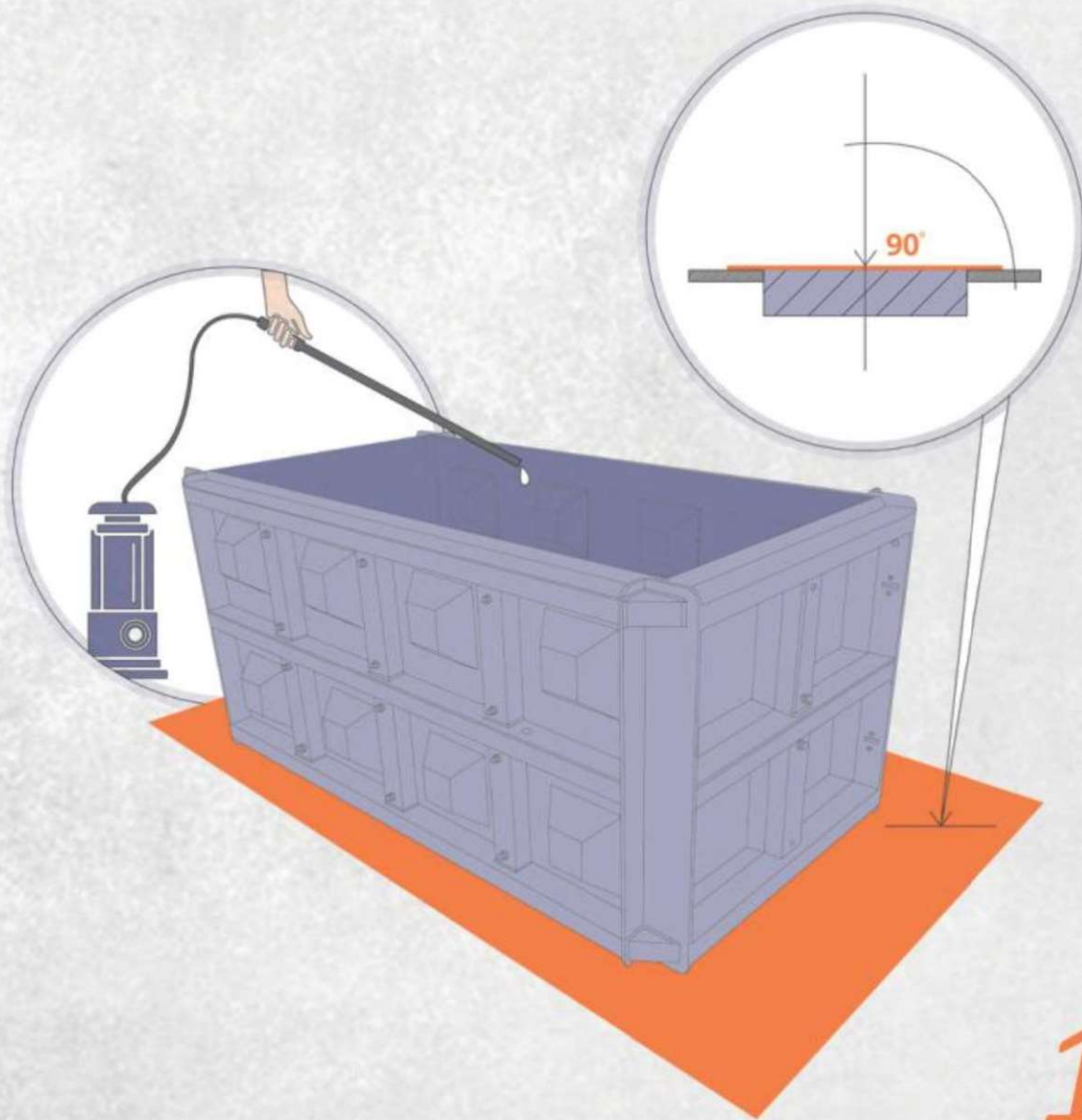

How to use mold



How to use mold



1.

*Place the mold on steel plate and flat/labeled surface.
Apply the oil (release agent) to the inside of the mold in
order to easily remove the block.*

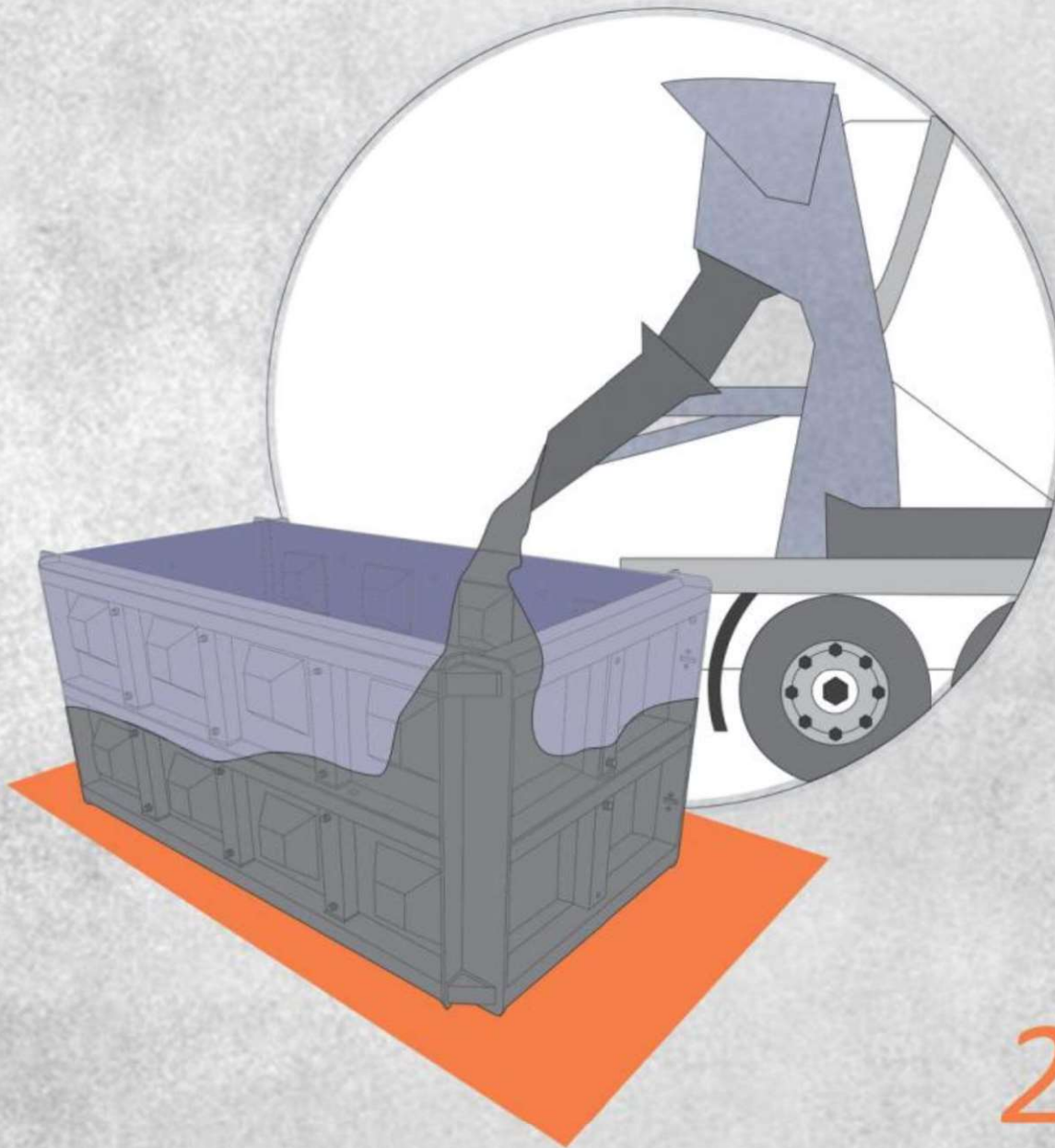

How to use mold



2.

Pour the concrete gradually in order to proper fill the mold.

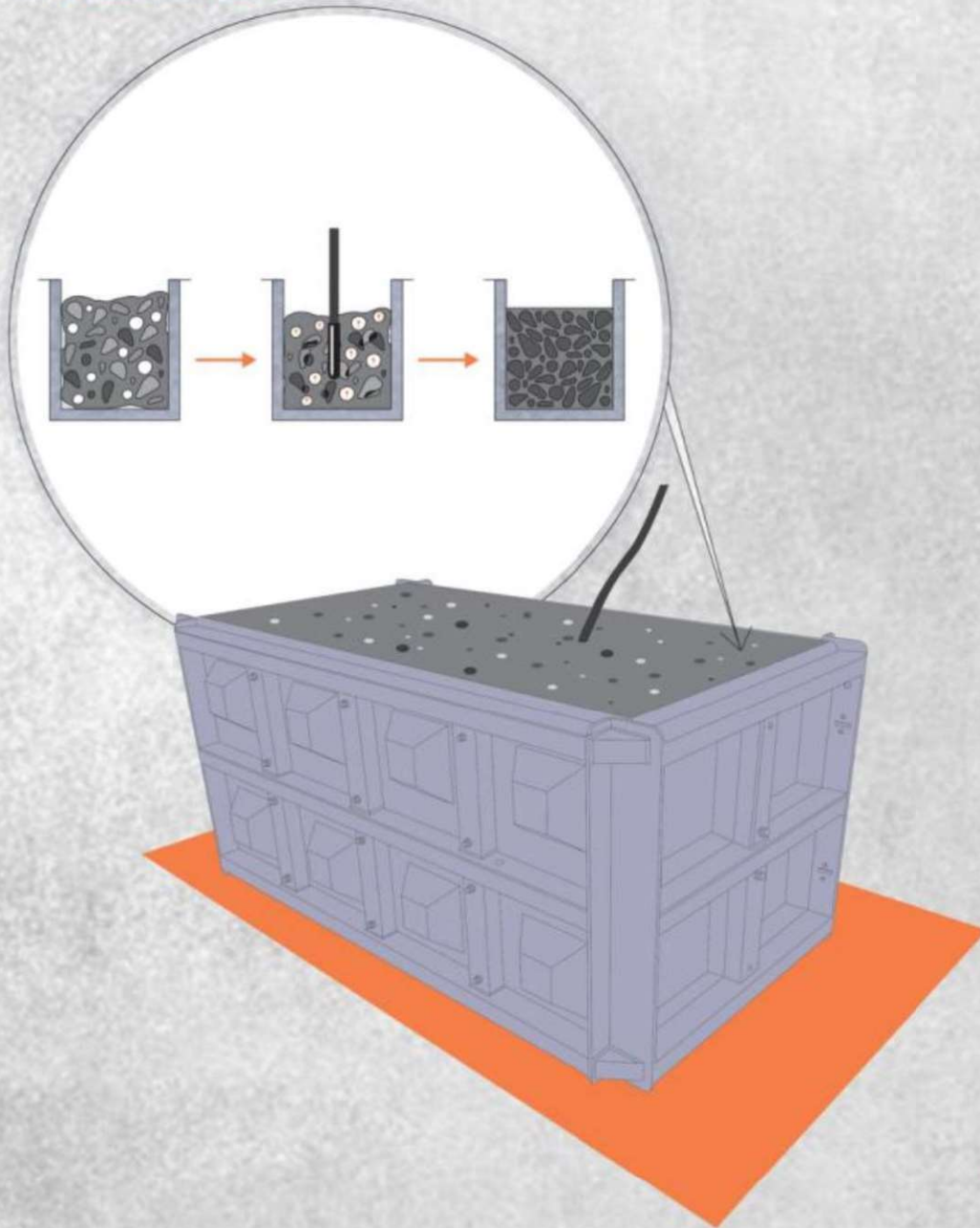

How to use mold



3.

During pouring the concrete must be vibrated in order to make it homogeneous and compact.



How to use mold



4.

Wait until concrete become solid. Curing time depends on type of concrete and weather conditions.

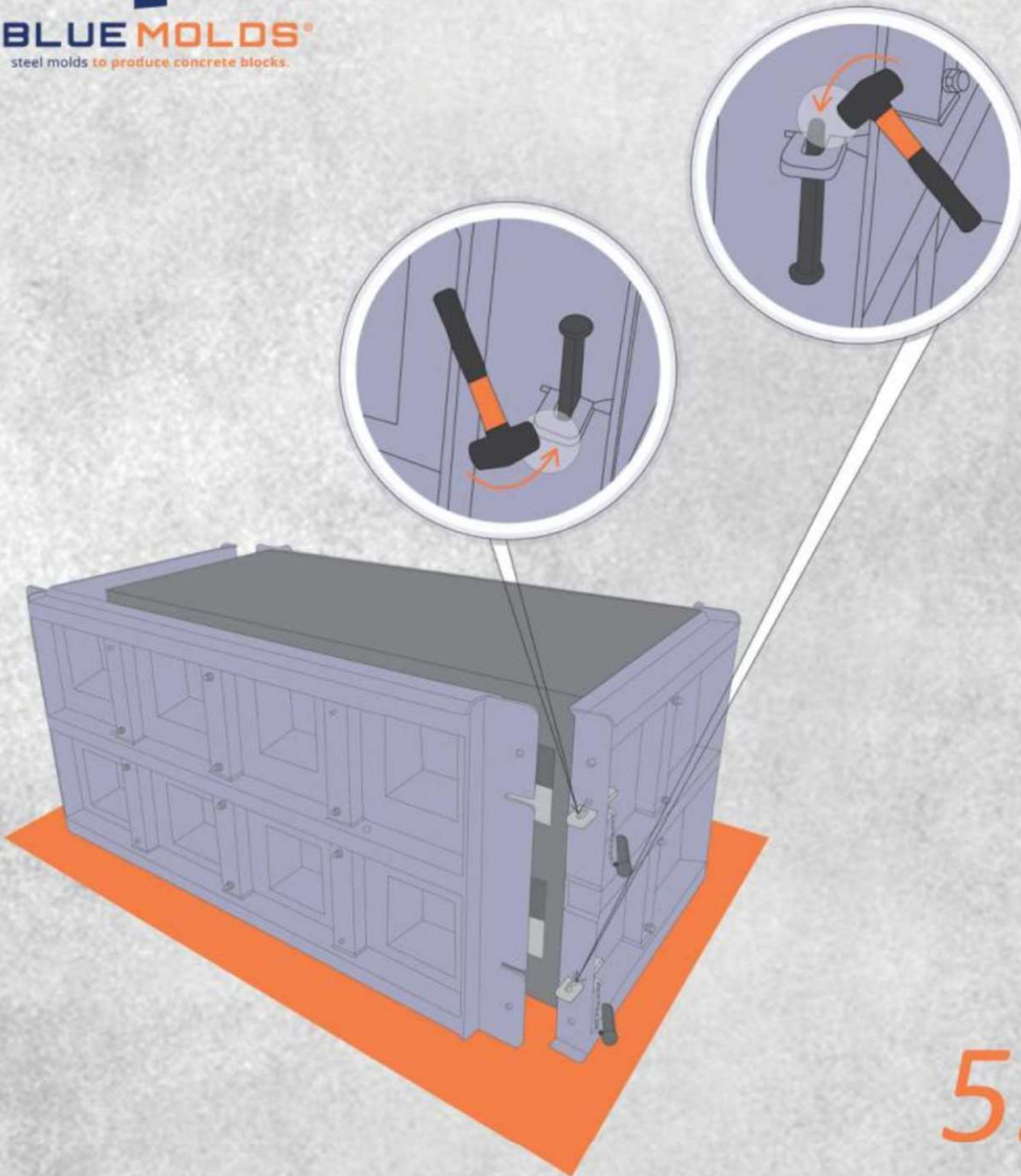

How to use mold



5.

Start opening the mold by removing wedges.

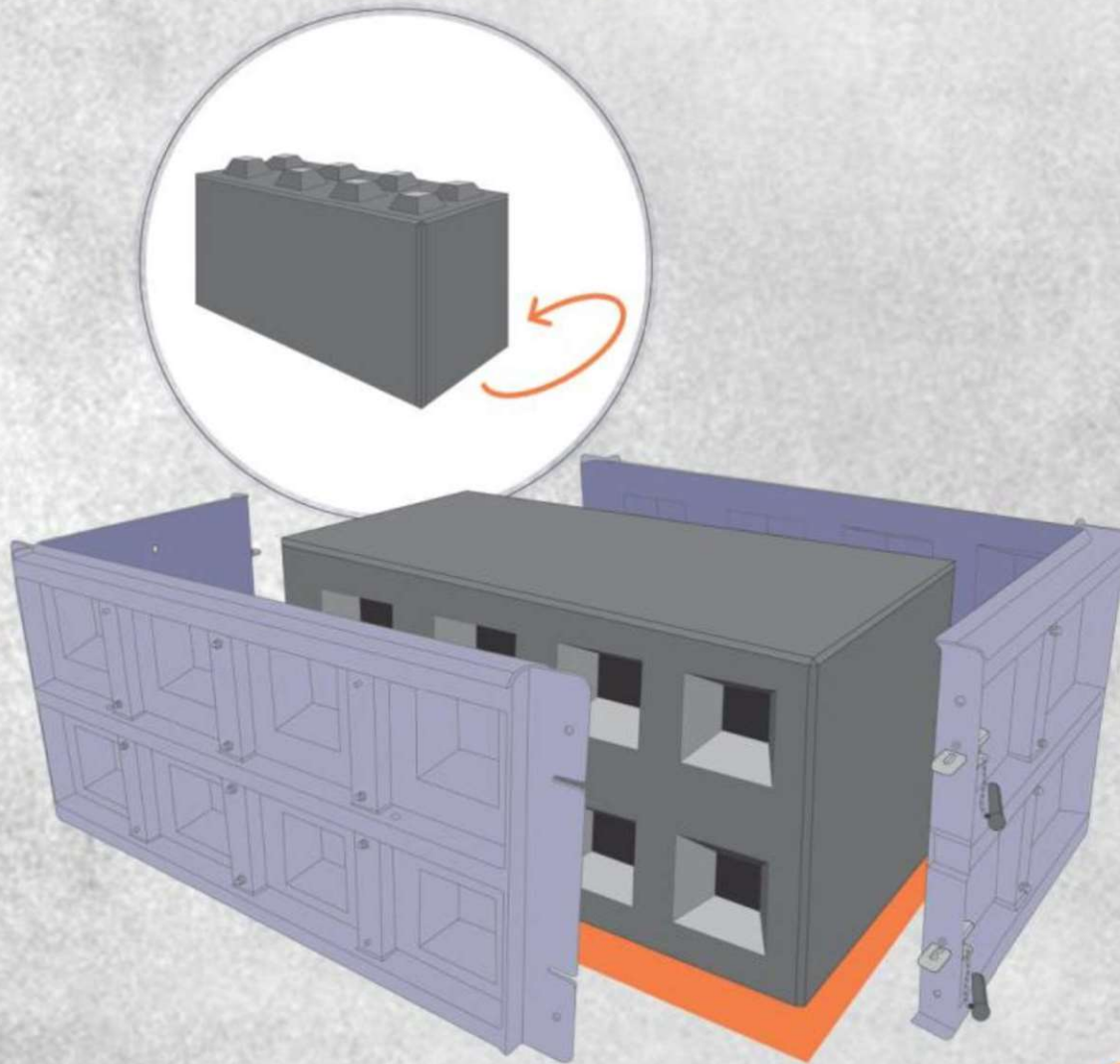

How to use mold



6.

After opening the mold concrete block should be lifted and rotated. Concrete block is ready to be used.

How to open/close the mold

Every mold is assembled from two (2) L-profile finished parts



*Divider should be inserted or removed and then close the mold.
Close the pins and wedges by using hammer.*

How to open/close the mold

Close the pins with cone and spherical wedges by using hammer.



How to open/close the mold



*Divider is fixed in the mold using shown
Divider Nut and Bolt M10x66*

*When divider is removed please use supplied
standard nut and bolt M10x66 (flat)*

How to use magnetic steel recess former and lifting accessories:

1.



2. *Position rubber on anchor*



How to use magnetic steel recess former and lifting accessories:

3. *Position anchor in magnetic steel recess former*



4. *Position magnetic steel recess former with anchor into the mold (in position on top of block)*

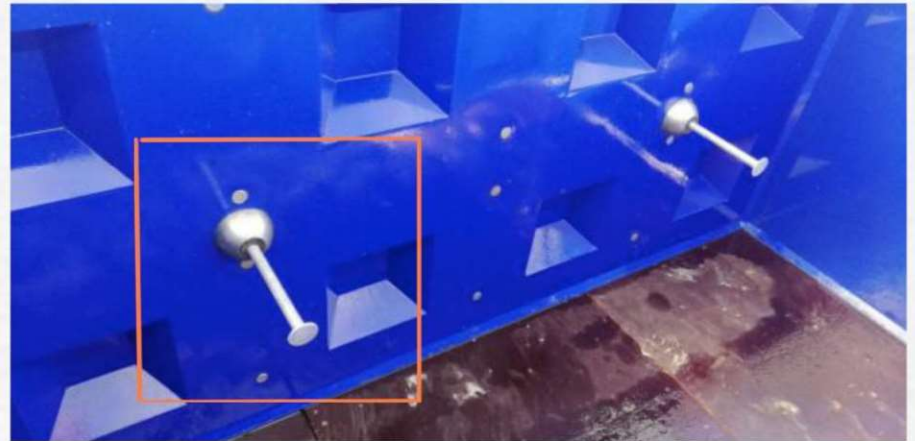

How to use magnetic steel recess former and lifting accessories:

- 5.** *Fill in the mold with concrete. After opening the mold magnetic steel recess former remains on mold and anchor is casted-in in the block. Remove the rubber for next use with magnetic steel recess former*



How to use magnetic steel recess former and lifting accessories:

6. Attach lifting eye/clutch to open end of anchor on the block and easily lift the block



Positions for anchors in the block/mold:
Solution 1 - Mold 1200-600-600
Solution 2 - Mold 1600-800-800



LIFTING EYE

